

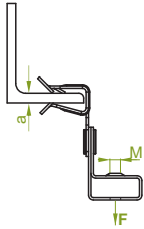

**Beam Clip**

ZSP1



**ZSP1...**

CODE	Thickness a mm	Dimension M mm	Safe Working Load F <sub>max</sub> [kN]	1.0 mm Catalogue No.	Qty
ZSP1M6/2	2-3	M6	0.70	790101	100
ZSP1M6/3	3-8	M6	0.90	790201	100
ZSP1M6/8	8-14	M6	0.90	790301	100
ZSP1M6/14	14-20	M6	0.90	790401	100
ZSP1M8/2	2-3	M8	0.70	790501	100
ZSP1M8/3	3-8	M8	0.90	790601	100
ZSP1M8/8	8-14	M8	0.90	790701	100
ZSP1M8/14	14-20	M8	0.90	790801	100
ZSP1M10/2	2-3	M10	0.70	790901	100
ZSP1M10/3	3-8	M10	0.90	791001	100
ZSP1M10/8	8-14	M10	0.90	791101	100
ZSP1M10/14	14-20	M10	0.90	791201	100



ZSP2

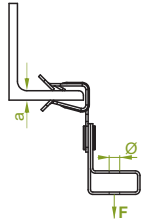

**ZSP2...**

CODE	Thickness a mm	Dimension Ø mm	Safe Working Load F <sub>max</sub> [kN]	1.0 mm Catalogue No.	Qty
ZSP211/2	2-3	11	0.70	791301	100
ZSP211/3	3-8	11	0.90	791401	100
ZSP211/8	8-14	11	0.90	791501	100
ZSP211/14	14-20	11	0.90	791601	100



ZSP3

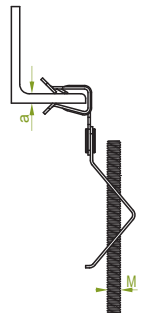

**ZSP3...**

CODE	Thickness a mm	Dimension M mm	Safe Working Load F <sub>max</sub> [kN]	1.0 mm Catalogue No.	Qty
ZSP3M6/2	2-3	M6	0.60	791701	100
ZSP3M6/3	3-8	M6	0.60	791801	100
ZSP3M6/8	8-14	M6	0.60	791901	100
ZSP3M6/14	14-20	M6	0.60	792001	100
ZSP3M8/2	2-3	M8	0.70	792101	100
ZSP3M8/3	3-8	M8	0.70	792201	100
ZSP3M8/8	8-14	M8	0.70	792301	100
ZSP3M8/14	14-20	M8	0.70	792401	100
ZSP3M10/2	2-3	M10	0.70	792501	100
ZSP3M10/3	3-8	M10	0.70	792601	100
ZSP3M10/8	8-14	M10	0.70	792701	100
ZSP3M10/14	14-20	M10	0.70	792801	100



**APPLICATION**

Suspending lightweight assemblies from strut open sections

ZSU1

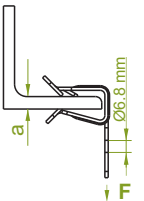

**ZSU1...**

CODE	Dimension a mm	Safe Working Load F <sub>max</sub> [kN]	1.0 mm Catalogue No.	Qty
ZSU113/2	2-3	0.70	797301	100
ZSU113/3	3-8	0.90	797401	100
ZSU116/2	8-14	0.90	797501	100
ZSU116/3	14-20	0.90	797601	100



ZSU2

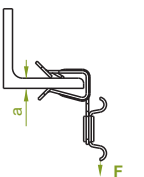

**ZSU2...**

CODE	Dimension a mm	Safe Working Load F <sub>max</sub> [kN]	1.0 mm Catalogue No.	Qty
ZSU213/2	2-3	0.15	797701	100
ZSU213/3	3-8	0.15	797801	100
ZSU216/2	8-14	0.15	797901	100
ZSU216/3	14-20	0.15	798001	100



**APPLICATION**

Suspending bunched cables from strut open sections

**MATERIAL**

Electro-galvanised (electroplated) spring steel

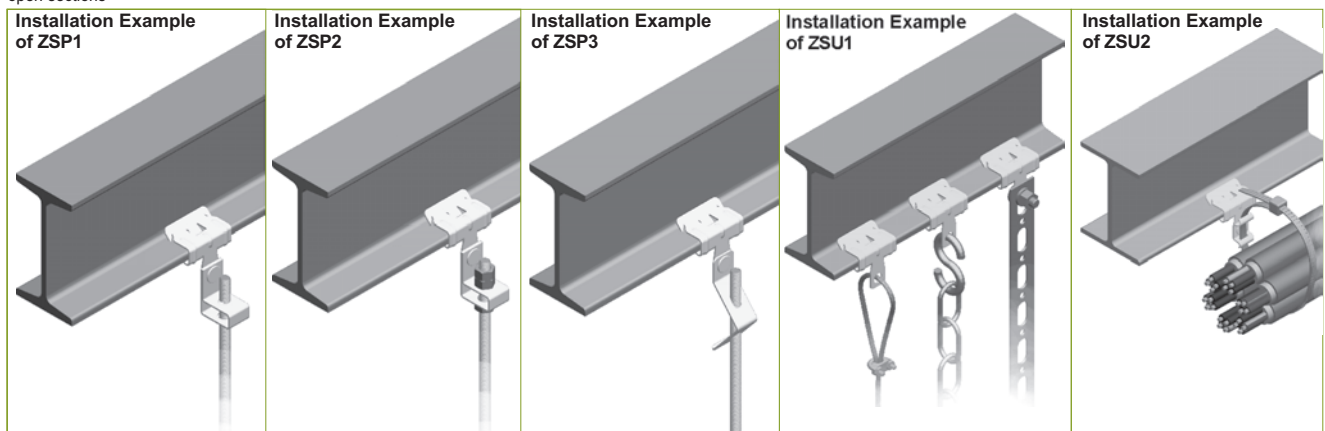



**Beam Clip**

ZSK1

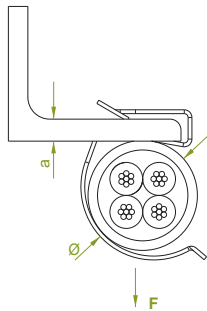

**APPLICATION**

Suspending cables and pipes from strut open sections

**ZSK1...**

CODE	Dimension a mm	Dia. Ø mm	1.0 mm Catalogue No.	Qty
ZSK1Ø6/2	2-4	6+7	792901	100
ZSK1Ø7/2	2-4	7+8	793001	100
ZSK1Ø8/2	2-4	8+9	793101	100
ZSK1Ø9/2	2-4	9+10	793201	100
ZSK1Ø10/2	2-4	10+11	793301	100
ZSK1Ø12/2	2-4	12+14	793401	100
ZSK1Ø15/2	2-4	15+18	793501	100
ZSK1Ø19/2	2-4	19+24	793601	100
ZSK1Ø25/2	2-4	25+32	793701	100
ZSK1Ø6/4	4-7	6+7	793801	100
ZSK1Ø7/4	4-7	7+8	793901	100
ZSK1Ø8/4	4-7	8+9	794001	100
ZSK1Ø9/4	4-7	9+10	794101	100
ZSK1Ø10/4	4-7	10+11	794201	100
ZSK1Ø12/4	4-7	12+14	794301	100
ZSK1Ø15/4	4-7	15+18	794401	100
ZSK1Ø19/4	4-7	19+24	794501	100
ZSK1Ø25/4	4-7	25+32	794601	100
ZSK1Ø6/8	8-12	6+7	794701	100
ZSK1Ø7/8	8-12	7+8	794801	100
ZSK1Ø8/8	8-12	8+9	794901	100
ZSK1Ø9/8	8-12	9+10	795001	100
ZSK1Ø10/8	8-12	10+11	795101	100
ZSK1Ø12/8	8-12	12+14	795201	100
ZSK1Ø15/8	8-12	15+18	795301	100
ZSK1Ø19/8	8-12	19+24	795401	100
ZSK1Ø25/8	8-12	25+32	795501	100



**Beam Clip**

ZSK2

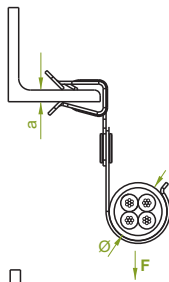

ZSK3

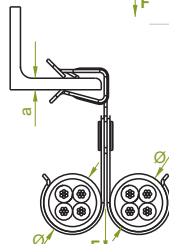

**APPLICATION**

Suspending cables and pipes from strut open sections

**ZSK2...**

CODE	Dimension a mm	Dia. Ø mm	1.0 mm Catalogue No.	Qty
ZSK213/2	2-3	10.9+13	796501	100
ZSK213/3	3-8	10.9+13	796601	100
ZSK216/2	2-3	12.4+16	796701	100
ZSK216/3	3-8	12.4+16	796801	100



**ZSK3...**

CODE	Dimension a mm	Dia. Ø mm	1.0 mm Catalogue No.	Qty
ZSK313/2	2-3	10.9+13	796901	100
ZSK313/3	3-8	10.9+13	797001	100
ZSK316/2	2-3	12.4+16	797101	100
ZSK316/3	3-8	12.4+16	797201	100



ZSK4

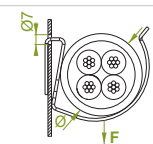

**APPLICATION**

Suspending cables and pipes from trapezoidal decking sheets.

**ZSK4...**

CODE	Dia. Ø mm	1.0 mm Catalogue No.	Qty
ZSK4Ø6	6+7	795601	100
ZSK4Ø7	7+8	795701	100
ZSK4Ø8	8+9	795801	100
ZSK4Ø9	9+10	795901	100
ZSK4Ø10	10+11	796001	100
ZSK4Ø12	12+14	796101	100
ZSK4Ø15	15+18	796201	100
ZSK4Ø19	19+24	796301	100
ZSK4Ø25	25+32	796401	100



**Clip**

AZSK 1



**APPLICATION**

Suspending lightweight assemblies from strut open sections. The adaptor can be used with Clips ZSK1 and channels 12 to 20mm thick.

**AZSK1**

CODE	Thickness a mm	1.0 mm Catalogue No.	Qty
AZSK1	12-20	790302	50



**MATERIAL**

Electro-galvanised (electroplated) spring steel

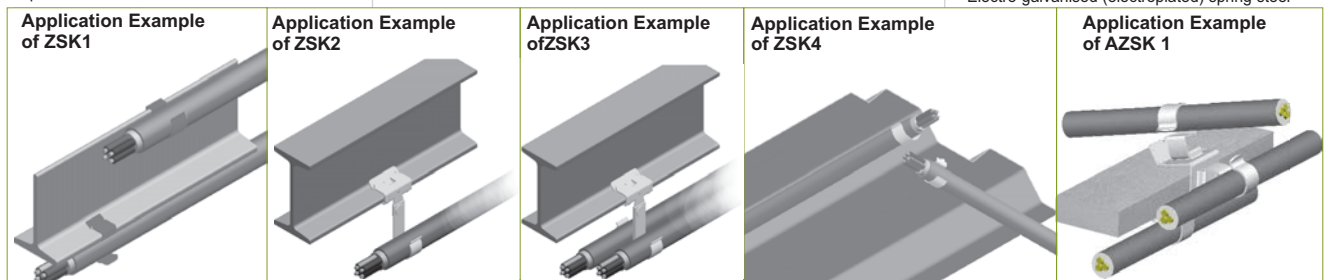

Thickn. (ga) [mm]: 0.5 0.7 1.0 1.2 1.5 2.0



**Purlin Clip**

ZS1

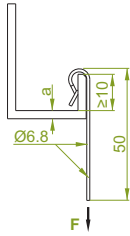

**ZS1...**

CODE	Thickness a mm	Safe Working Load F <sub>max</sub> [kN]	1.0 mm Catalogue No.	Qty
ZS11	1.5-4.0	0.70	790103	100
ZS12	4.0-6.5	0.70	790203	100



ZS2

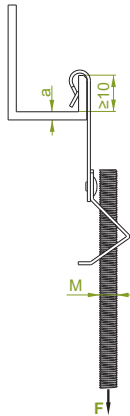

**ZS2...**

CODE	Thickness a mm	Dimension M mm	Safe Working Load F <sub>max</sub> [kN]	1.0 mm Catalogue No.	Qty
ZS21M6	1.5-4	M6	0.60	790303	100
ZS21M8	1.5-4	M8	0.70	790403	100
ZS21M10	1.5-4	M10	0.70	790503	100
ZS22M6	4.0-6.5	M6	0.60	790603	100
ZS22M8	4.0-6.5	M8	0.70	790703	100
ZS22M10	4.0-6.5	M10	0.70	790803	100



ZS3

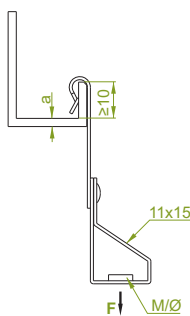

**ZS3...**

CODE	Thickness a mm	Dimension M/Ø mm	Safe Working Load F <sub>max</sub> [kN]	1.0 mm Catalogue No.	Qty
ZS31M6	1.5-4	M6	0.70	791003	100
ZS31M8	1.5-4	M8	0.70	791103	100
ZS31M10	1.5-4	M10	0.70	791203	100
ZS32M6	4.0-6.5	M6	0.70	791303	100
ZS32M8	4.0-6.5	M8	0.70	791403	100
ZS32M10	4.0-6.5	M10	0.70	791503	100
ZS33	1.5-4	11	0.70	791603	100
ZS34	4.0-6.5	11	0.70	791703	100



**APPLICATION**

Suspending lightweight assemblies from strut open sections

**MATERIAL**

Electro-galvanised (electroplated) spring steel





**Deck Hanger**

WST1

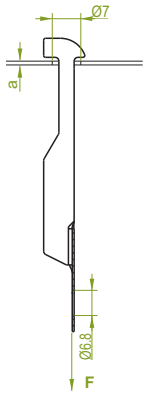

WST2

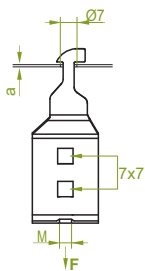

**WST1**

CODE	Dimension	Safe Working Load F <sub>max</sub> [kN]	1.0 mm Catalogue No.	Qty
	a mm			
WST1	0.8-2	0.45	798101	100
	2-3	0.90		



**WST2...**

CODE	Dimension	Dimension	Safe Working Load F <sub>max</sub> [kN]	1.0 mm Catalogue No.	Qty
	a mm	M mm			
WST2M6	0.8-2	M6	0.45	798301	100
	2-3		0.60		
WST2M8	0.8-2	M8	0.45	798501	100
	2-3		0.90		
WST2M10	0.8-2	M10	0.45	798701	100
	2-3		0.90		



**APPLICATION**

Suspending lightweight assemblies from trapezoidal decking sheets.

**MATERIAL**

Electro-galvanised (electroplated) spring steel

**Application Example of WST1**

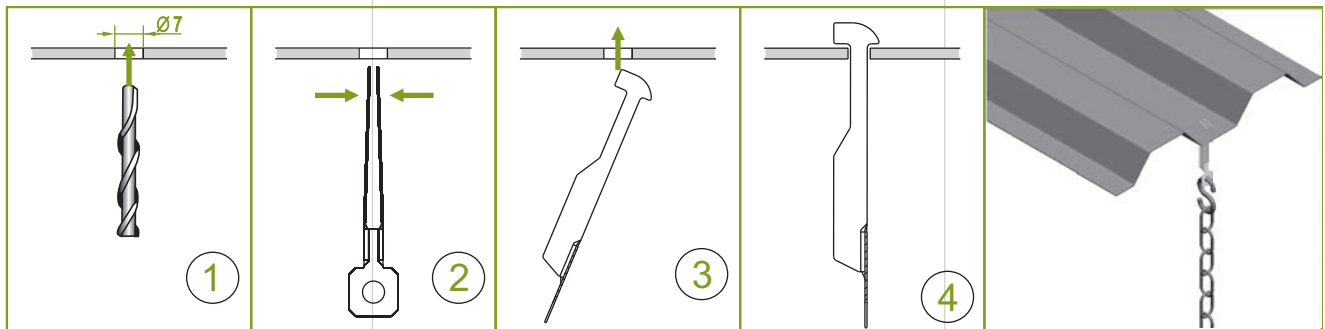

**Electro-galvanised (electroplated) spring steel WST2**

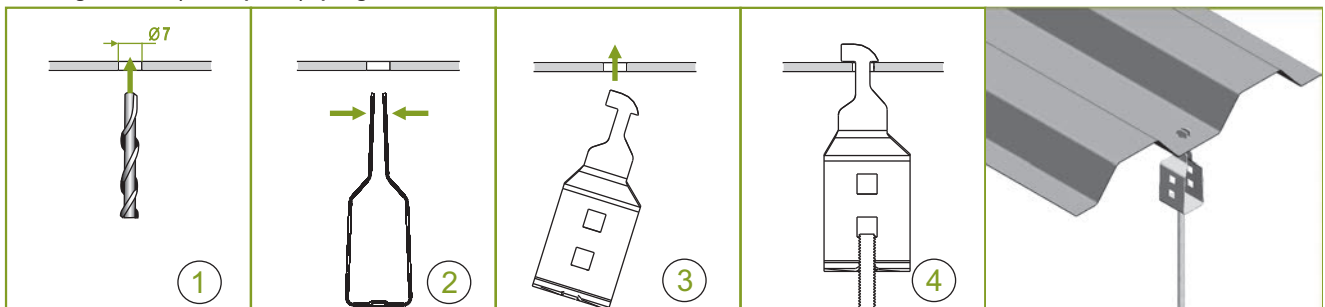

Thickn. (ga) [mm]: 0.5 0.7 1.0 1.2 1.5 2.0



**Tiger Clip**

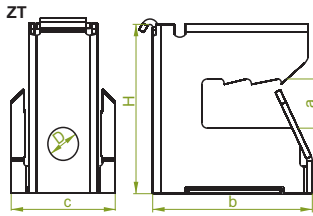

**APPLICATION**  
Suspending lightweight assemblies from strut open sections

**ZT...**

CODE	Dimension		Dimension		Height H mm	Safe Working Load F <sub>max</sub> [kN]	Catalogue No.	Qty
	a mm	b mm	c mm	D mm				
ZT8	2-8	30	19	6	30	1.20	790102	100
ZT16	8-16	32	19	6	38	1.20	790202	100

**Quick installation to steel structures**

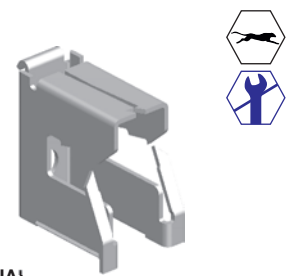

**MATERIAL**  
Electro-galvanised (electroplated) spring steel

**Cable Clamp**

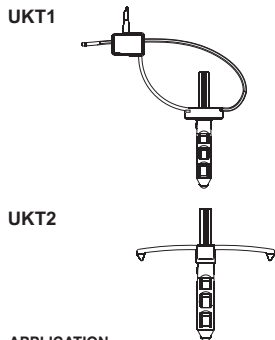

**APPLICATION**  
Quick cables installation to the wall or ceiling

**UKT1**

CODE	Drilled-Hole Depth L mm	Drill-Bit Dia D mm	Catalogue No.	Qty



**UKT2**

CODE	Drilled-Hole Depth L mm	Drill-Bit Dia D mm	Catalogue No.	Qty

**MATERIAL**  
Polypropylene PP.

**Installation Example of ZT**



**Application Example of UKT1**

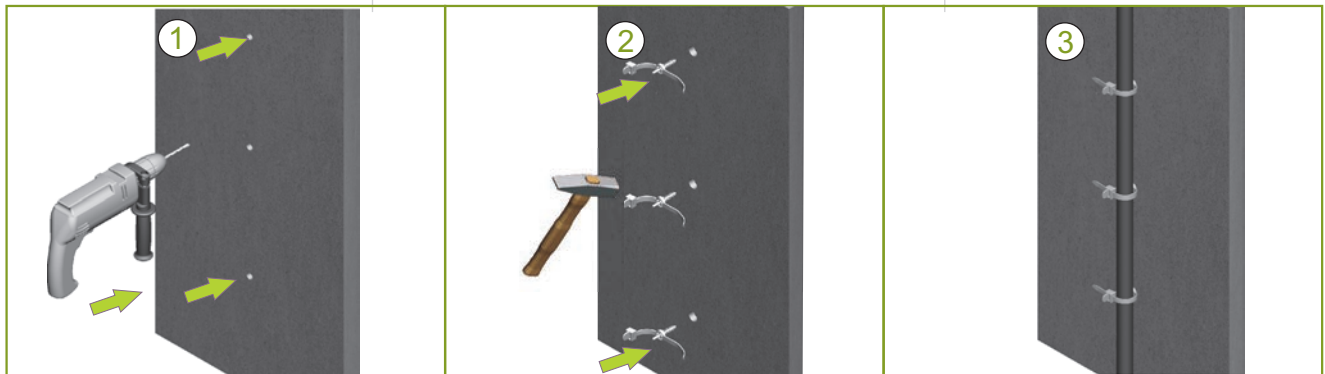

**Application Example of UKT2**

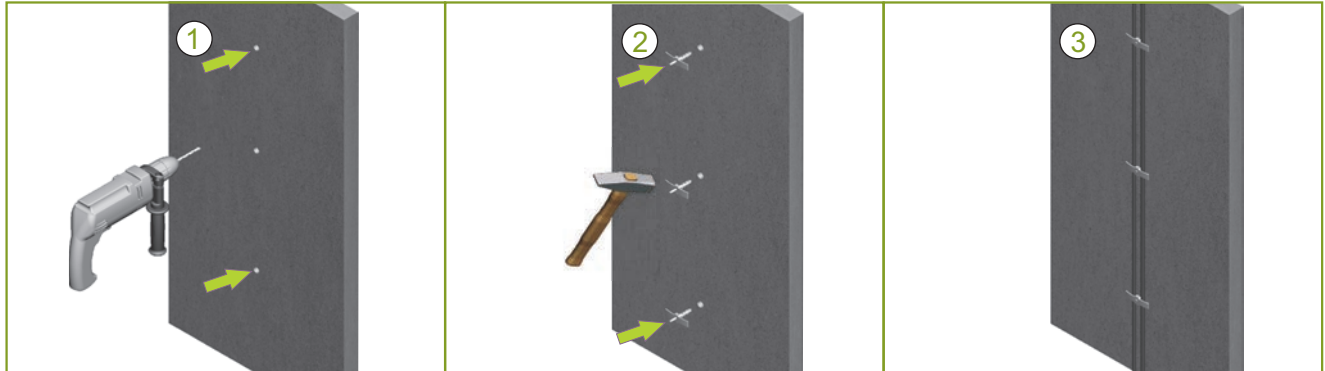



**Self Locking Clip**

USZ

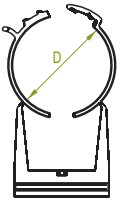

**USZ...**

CODE	Dia. D mm	Catalogue No.	Qty
USZ 12	10-12	790602	150
USZ 15	14-16	790702	100
USZ 18	16.5-20	790802	100
USZ 22	20-23	790902	100
USZ 26	25-29	791002	50
USZ 32	32-35	791102	50
USZ 42	40-45	791202	25
USZ 50	48-55	791302	25
USZ 60	58.5-60	791402	20



**Rail**

SZPL

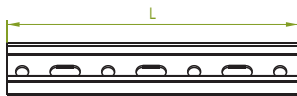

**SZPL**

CODE	Length L mm	Catalogue No.	Qty
SZPL	1000	791502	10



**Locking Block**

BLS

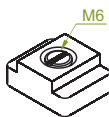

**BLS**

CODE	Catalogue No.	Qty
BLS	791602	50

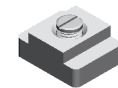

**Square Nut**

NMU

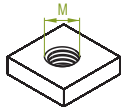

**NMU**

CODE	Thread M mm	Catalogue No.	Qty
NMU	6	791702	50



**APPLICATION**

Pipe and cable fixing system 10 to 65mm of dia. The clips can be used for both internal and external applications. This fixing is designed for use in heating and sanitary systems, as well as in mechanical and electrical installations..

**MATERIAL**

Polyamide 6 - modified (nylon PA6).

**Wall Plug**

SDD



**SDD**

CODE	Thread M mm	Catalogue No.	Qty
SDD	6	791802	50



**APPLICATION**

Installing Self Locking Clip USZ

**MATERIAL**

Electro-galv. steel (EG).

**Installation Examples of USZ**

